

LED WALL WASHER - RGB SERIES

The RGB LED WALL WASHER SERIES is a set of robust color-washing fixtures that create dynamic, full RGB color mixes, producing up to 16 million colors and projecting light up to 65 feet. High power LEDs are rated for up to 100,000 hours and require no maintenance, saving energy and labor costs. The durable housing are sealed, rated IP65, manage heat dissipation efficiently, keeping the LEDs cool. The fixtures meet the needs of lighting designers, architects and specifiers by offering an exciting new array of effect lighting possibilities, both interior and exterior.



BUILDING FACADES SIGNS COLUMN LIGHTING STATUARY
BACKLIGHTING NIGHTCLUBS HOTELS RESTAURANTS

FEATURES

- Full RGB color mixing produces 16 million colors
- High brightness LEDs create a bright wash of light, projecting up to 65 feet
- Link up to 30 Wall Washers in a single run
- Link multiple controllers together to create large scale synchronized lighting effects
- Adjustable angle design and easy installation maximizes on site flexibility
- Long life, low maintenance LEDs last up to 100,000 hours
- DMX 512 compatible
- All units feature durable aluminum alloy housing with IP65 rating for plug-in use in wet locations (provide GFCI protection)
- Housing design keeps cool and protects electronics and LEDs from heat, prolonging life
- Suitable for heavy duty use (more than 12 hours per day)
- Three year warranty

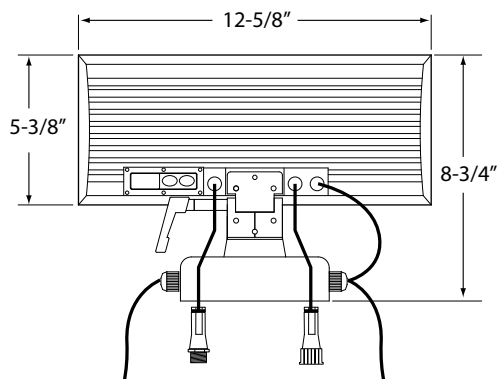

LW36-RGB, REAR VIEW

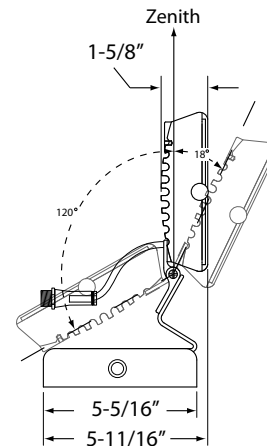

LW36-RGB, SIDE VIEW

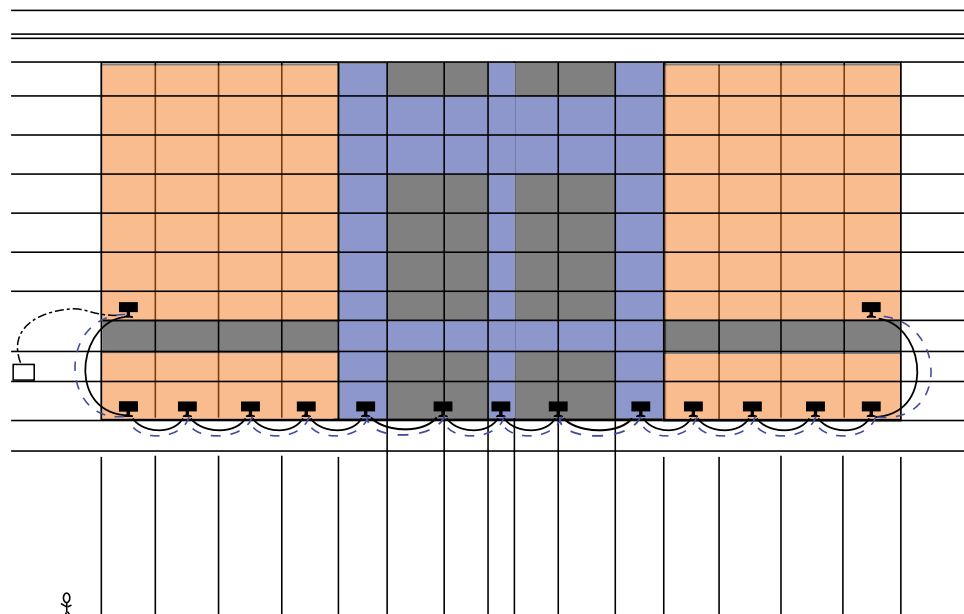

Bill of materials for Invesco Field at Mile High installation:

- (15) LW36-RGB
- (14) LW36-EC15
- (14) LW36-EX15
- (1) DMX-HD
- (1) CUSTOMCABLE

LEGEND:

- WALL WASHER FIXTURE (LW36-RGB)
- DMX INTERFACE (DMX-HD)
- SIGNAL CABLE (LW36-EC15)
- POWER CABLE (LW36-EX15)
- XLR3 ADAPTER CABLE (CUSTOMCABLE)

LED LINEAR RGB WALL WASHER

The LED LINEAR RGB WALL WASHER

SERIES is a set of robust color-washing fixtures that create dynamic, full RGB color mixes, producing up to 16 million colors and projecting light up to 65 feet. High power LEDs are rated for up to 100,000 hours and require no maintenance, saving energy and labor costs. The durable housing is sealed, rated IP65, manages heat dissipation efficiently, keeping the LEDs cool. The fixture meets the needs of lighting designers, architects and specifiers by offering an exciting new array of effect lighting possibilities, both interior and exterior.

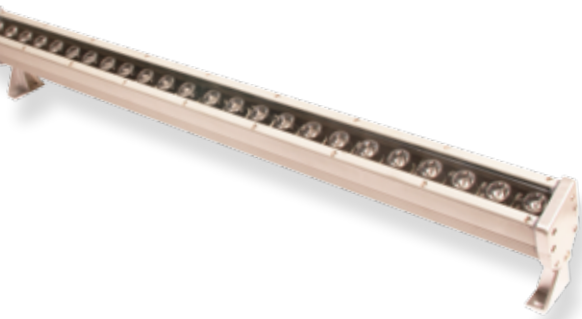

P



BUILDING FACADES SIGNS STATUARY
BACKLIGHTING NIGHTCLUBS HOTELS RESTAURANTS



SIDE VIEW

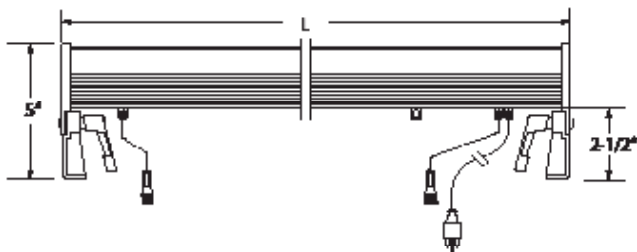

REAR VIEW

FEATURES

- Full RGB color mixing produces 16 million colors
- High brightness 1 watt LEDs create bright, dynamic wash of light, projecting up to 20 meters (65 feet)
- Sets of Red, Green and Blue LEDs are controllable via RGB controller, which also can be used as DMX interface
- Durable die-cast powder coated aluminum housing is sealed for use in wet locations (IP65)
- Easy to install – each unit has five foot cord with grounded plug (use with GFCI weatherproof outlet for each outdoor unit) and durable standoffs with mounting holes for affixing to various mounting surfaces
- Long life, low maintenance LEDs last 100,000 hours (average life)
- Link up to 30 units together to one controller for synchronous lighting effects
- LED sources save significantly in energy and maintenance costs when compared to any other type of flood light source
- Available in three lengths with adjustable tilt with locking handle design allows on-site housing angle control
- Three year warranty

BILL OF MATERIALS

See linear layout example below and LW36-RGB on page 5 for assistance in determining a bill of materials.

- Determine height and width of area to be lighted
- Determine how far fixtures will be from area to be lighted
- Determine how many Wall Washers to be used*
- For synchronous color control, order one LW36-CON for each run of thirty units or less
- For advanced color control, order one DMX-HD and one LW36-XLR3 for each run of thirty units or less
- Determine quantity of fifteen foot signal cables, if needed
- Determine quantity of fifteen foot power cables, if needed (indoor use only). For outdoor use, ensure that each Wall Washer has a GFCI weatherproof outlet within five feet of its location.

* For continuous wall wash effect, linear fixtures should be placed end-to-end and at least 4" from wall or surface to be lighted.

See next page to determine level of control needed (whether to specify either LW36-CON or LW36-XLR with DMX-HD).

Note: Performance is influenced or affected by surface color (reflectance) & ambient light levels. Ex. Competing light sources.

Bill of materials for 40 foot wall installation below:

- (10) LW36X1-RGB
- (1) LW36-CON

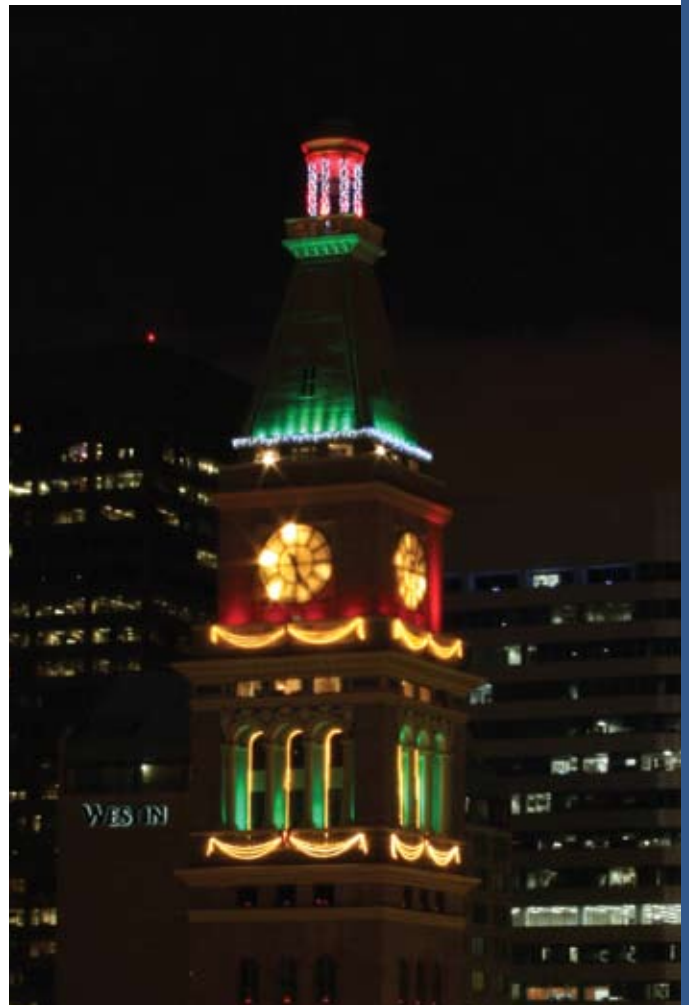

INSTALLATION EXAMPLE

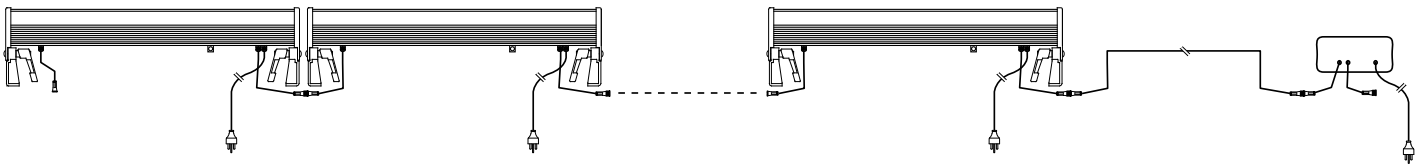

Each Linear RGB Wall Washer requires its own outlet or extension cord to a receptacle. However, there is no "power out" cable to link power from one to the next when using the linear form factor. Data cable can be linked directly, or by using signal extension cables. See page 9 for accessories.

TECHNICAL SPECIFICATIONS

Voltage	120V AC, 60 Hz
Construction	Aluminum alloy housing and integrated driver with IP65 rating, fully sealed for use in wet locations, black enamel finish (for LW36-RGB) silver enamel for Linear Wall Washers
Mounting	Integrated mounting holes in housing legs/brackets
Dimensions	LW36-RGB: H = 8-3/4", W = 12-5/8", D = 5-11/16"; Linear units: H = 5", W = 2-3/16", Available lengths = 15-3/4", 31-1/2" and 47-1/4"
Control leads	12" input power and 12" output power adapter lead (LW36-RGB only); 12" input signal and 12" output signal, mini 3-pin signal connector
Switching	Use switched outlet to control power to controller or streamer
Wattage	LW36-RGB = 48 watts; LW12X1-RGB = 21.6 watts, LW24X1-RGB = 43.2 watts, LW36X1-RGB = 64.8 watts
Maximum run	For signal: 3,000 feet between controller and final fixture; for "daisy-chaining" indoors 120V power (LW36-RGB): 30 wall washers
Linking data	Interconnect directly for 18" spacing; use fifteen foot signal cables (interconnectable to create longer lengths) for linking multiples
Packaging	White box
LED specs	100,000 hour rated life, high power (1-watt) LEDs, Red: 2.4V, Green and Blue: 3.6V, 350mA, 5mm, 25° beam angle
Dimmers	Use with DMX compatible interface and DMX controller; not dimmable with wall dimmers
Diffuser	Clear polycarbonate lens
DMX	Three channels, compatible with USITT standard DMX512 output lighting control software

WHAT LEVEL OF COLOR CONTROL DO YOU NEED?

'Demo' mode (continuous sequence of color fade, color sequence, color washes):

For a demonstration of simple effects (such as fixed color, color sequence and color wash), you do not need a controller. Each fixture is factory-set to ID = **001** as indicated on the lighted screen on the back of the array. (See illustration below for location of lighted screen) If the ID is left as 001, the unit will continuously advance through a factory-set color sequence "demo".

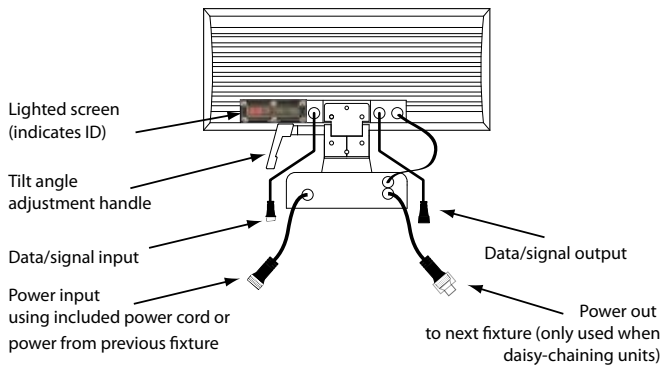

Stop on pre-programmed colors, continuous fades, color wash sequences and adjust intensity:

The LW36-CON controller is required to produce synchronous color changing mixes. Various preprogrammed user buttons make it easy to set specific colors and also types of color sequences with separate fade rates. The LW36-CON controller must remain connected to the set of LED Wall Washers it is controlling.

Customize colors, light shows, multi-channel scenes:

For more advanced and/or customized lighting control, the LED Wall Washer can be connected to any standard USITT DMX 512 controller (like via interface DMX-HD), allowing the LED Wall Washer to be integrated into any type of automated or programmed light show. The adapter cable LW36-XLR3 or LW36-XLR3-15 is required to connect the LW36 Wall Washer's signal cable to XLR3 equipment.

DMX 512 products typically interface with either 5-pin or 3-pin XLR3 type connectors. Regardless of whether it is a 3-pin or a 5-pin system, the pin configurations for DMX 512 are standard on pins 1, 2 and 3:

Pin 1 = Shield
Pin 2 = DMX-
Pin 3 = DMX+

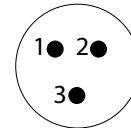

The City and County Building in Denver, Colorado utilizes over 550 individually addressed LED Wall Washers. Contact American Lighting for assistance when special cabling and/or expert DMX programming is required.

INSTALLATION EXAMPLES

Provide a GFCI protected receptacle for each unit (outdoor installations).

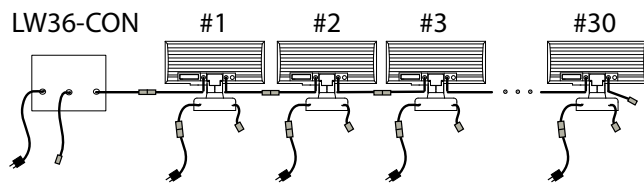

Daisy-chain power to units using LW36-EX15 power extension cable (LW36-RGB indoors only).

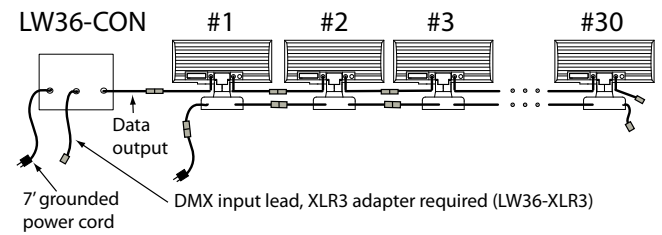

FIXTURE

LW
Color Changing
Fixture

— — **RGB**

12X1 = 12 LEDs, 15-3/4" length, 21.6 watts
24X1 = 24 LEDs, 31-1/2" length, 43.2 watts
36X1 = 36 LEDs, 47-1/4" length, 64.8 watts
36 = 36 LED array, 48 watts

ACCESSORIES



LW36-EC10, LW36-EC15
Ten or fifteen foot signal extension cable; male and female mini 3-pin connectors connect data between fixtures; can be interconnected to create longer lengths



LW36-EX15
Power extension cable for inter-connecting 120V power up to ten LW36-RGB units only, fifteen foot length



LW36-XLR3
Two foot adapter cable for DMX; male mini 3-pin connects to first fixture, female XLR3 connects to DMX-HD



LW36-XLR3-15
Fifteen foot adapter cable for DMX; male mini 3-pin connects to first fixture, female XLR3 connects to DMX-HD



DMX-HD
Hardwire interface box with software for MAC and PC and adapter cable; USB connects to dedicated laptop/computer, RC232 connects to DMX-HD



LW36-CON
Controller for LED Wall Washer, 7 preset colors, some stored functions including fade and speed control, 120V AC, 6' power cord

Note: Custom 5-pin to 3-pin adapter cables can be ordered (CUSTOMCABLE). Call factory with custom cable requirements.

Not every installation requires DMX. Factory presets allow multiple static colors and simple fade operations. Specify DMX equipment when specific color matching is required and/or when fixtures need to have different colors and values simultaneously. Call factory for details.